



Procedures for Swimming

Version	Date	Actions taken	Responsibility
1	10.05.15	Policy reviewed	Andrew Barnes
2	27.04.17	Policy reviewed	Laura Smith
3	06.12.22	Policy reviewed	Rachel Hyde
4	16.01.23	Policy to be reviewed	Standards and Improvement Committee

Swimming

Details of the Pool

Queen Edith has an outdoor pool with a shallow end 2' 9" in depth and a deep end 4' 9" in depth. The pool is 15.40 m in length and 6 m width.

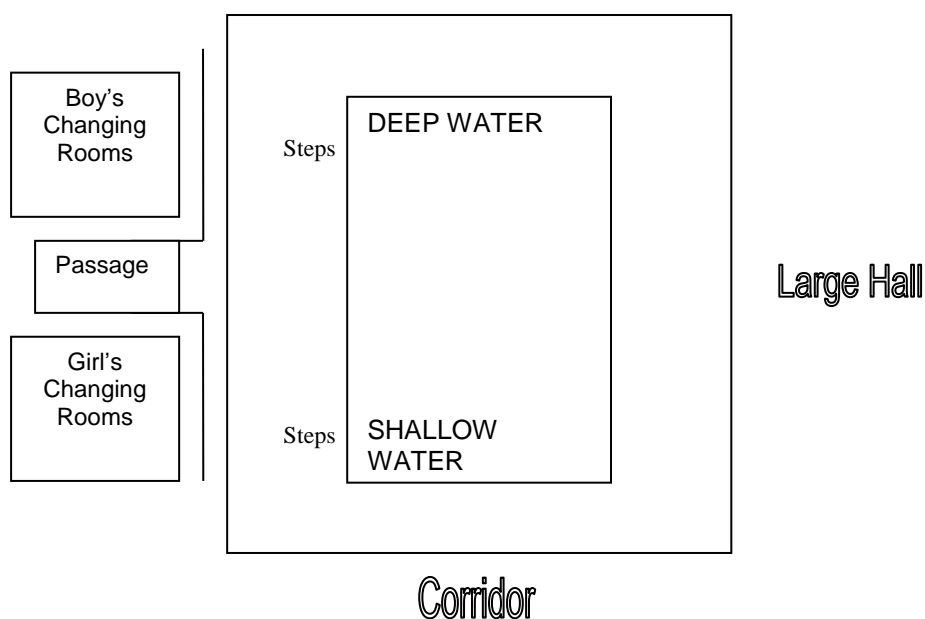

During the Summer term, when swimming is in progress, equipment is stored in the swimming pool areas under cover near the door to the bins. The first class to swim in the day will set out the equipment by the poolside and the final class to swim each day will return it to the passageway. After each session, all equipment should be returned neatly to its correct container and must not be left in the pool or on poolside.

Procedures for children to follow

- Children may only enter the changing rooms when authorised to do so by the class teacher.
- Children should change quietly and sensibly and use the toilet before leaving the changing room.
- Once changed, children must take their towel and footwear to the platform areas by the pool as shown in the diagram overleaf.

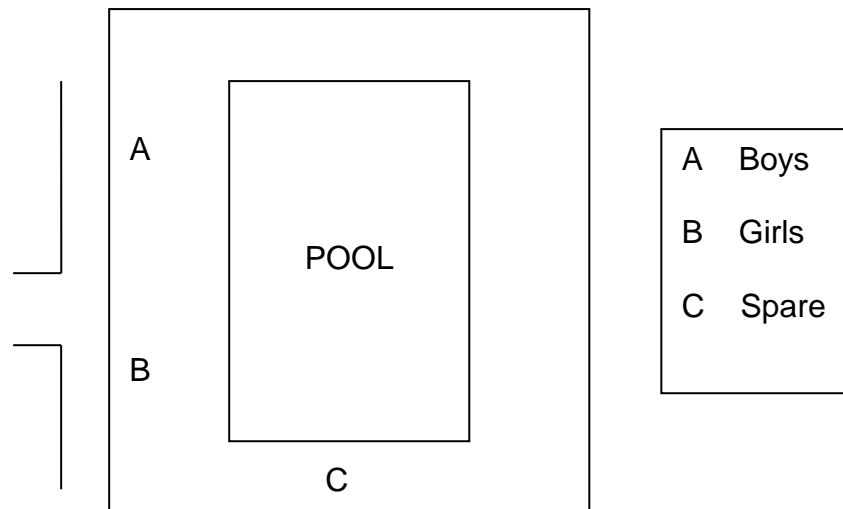

- Children may only enter the pool area/water under supervision of the teacher.
- Children requiring medication, such as inhalers for asthmatics, should bring these to the poolside.
- Children must not dive in either the shallow or deep water areas.
- Children must behave sensibly in the water at all times – no ducking/splashing etc, and work quietly.
- Children must follow safety whistle signals
 - When the whistle is **blown once**, the children must stop work and stand still/tread water to listen to the teacher.
 - To **evacuate the pool at the end of the session, the whistle should be blown once** and the children instructed to swim or walk to the side of the pool nearest the changing rooms. Children must leave the pool by the steps one at a time unless otherwise directed.
 - When **three whistles are blown consecutively**, the children must swim or walk to the nearest side of the pool immediately and wait, because emergency procedures are taking place. The children do not talk or leave the pool unless instructed to do so by the teacher.
- At the end of the session, the children should exit the pool area using the fire exit when instructed to do so.
- Jewellery, including watches, studs for pierced ears, and cultural or religious adornments must be removed during lessons involving physical exercise (including swimming). If such items cannot be removed, the individual is not prepared in an acceptably safe way and cannot continue as is, so must take part in modified activity. The school will not accept responsibility for removing or storing studs. Taped earrings are not an alternative to removal.

Procedures for teachers to follow

- A minimum of two adults must be present at all times – **both** of whom must be trained this year in deep water recovery and **both** of whom must have attended this year's resuscitation training.
- Children receiving medication, which may affect their ability to swim, or who suffer from conditions such as epilepsy or diabetes, must be watched by an assigned adult at all times.
- The door to the corridor must be unlocked, as well as the door to the changing rooms.
- **Follow the pool ratio:**

TABLE 10A ABILITY/AGE/ACTIVITY	BASELINE LEARNER/TEACHER RATIOS	QUALITY DELIVERY LEARNER/TEACHER RATIOS
Non-Swimmers and beginners - young children , normally primary school age, being introduced to swimming who are unable to swim 10 metres unaided on back or front.	12:1	8:1
Children under the age of seven - Irrespective of their swimming ability, group size should be restricted.	12:1	8:1
Improving swimmers - Swimmers of a similar ability to each other who can swim at least 10 metres competently and unaided on their back and on their front. It is recommended that the lesson be confined to an area in which the children are not out of their depth.	20:1	12:1

The class teacher must:

- Be familiar with and instruct parent helpers about safety procedures.
- Check the risk factors in and around the pool before the lesson begins;
- Make the children aware of the shallow and deep water areas at the beginning of the unit of work;
- Assess the children's ability in the first week of the unit of work and base groupings upon this;

- Follow the county regulations that the children must be able to swim 100m if the lesson is to be conducted in water too deep for the child to stand. (This is 7 lengths of Queen Edith Pool)
- Ensure that the whole pool can be observed at all times.
- Have the safety pole and first aid kit within easy reach during the lesson
- Conduct the lesson using a whistle
- Check the number of children in the group before, during and after each session.
- The lowest water temperature in which children can swim is **54F (12.2C)**.
- Check children are prepared for the swimming lesson before entering the pool with reference to the jewellery statement above.
- Ensure that any equipment used is of a good standard and report any broken equipment.

Emergency Procedures

All class teachers, swimming coaches, teaching assistants and parent helpers must be familiar with the emergency procedures to be followed in the event of a child being in serious difficulty in the pool.

1. The class teacher is to blow the whistle three times. The children in the pool should automatically swim/walk to the nearest pool side and hold on to the edge of the pool.
2. Immediate action must be taken to rescue the child – either by using the safety pole or entering the water.
3. The second adult must check that all the other children are holding the pool side and are in no danger.
4. One adult must apply resuscitation techniques as necessary.
5. The second adult must be prepared to send a message to the office or another member of staff. Two card notices are available at the poolside.
 - i) The red card entitled **“SWIMMING POOL”** means urgent assistance required.
 - ii) The red card entitled **“SWIMMING POOL: AMBULANCE”** means urgent assistance required and send for an ambulance.
6. The pool should be cleared calmly and safely using the steps only.